

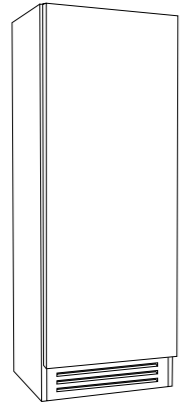

Integrated Series Model S7490FZ



| Dimensions | |
|---------------------------------------|-------------------|
| Width | 737 mm |
| Height | 2050 mm |
| Depth | 610 mm |
| Weight Net | 190 kg |
| Minimum Niche Height | 2064 mm |
| Door Clearance | 1285 mm |
| Door Opening Angle | <105° |
| Technical Specifications | |
| Energy Efficiency Class | A+ |
| Energy Usage | 438 Kwh |
| Noise Level | 41 dB |
| Fridge/Riserva Compart. Capacity | 438 l |
| Fresco/Wine Cellar Compart. Capacity | - |
| TriMode Compart. Capacity | - |
| Features | |
| Freezer Compartment | |
| Shelves | 2 |
| Door Shelves | 2 |
| Large Drawers | 3 |
| Model Options | |
| Door Opening Left (3) /Right (6) | 3 |
| Ice Maker | ✓ |
| Connection data | |
| Voltage | AC 220-240V 50 Hz |
| Power supply cable | Schuko 16 A |
| Length power supply cable | 2,0 mt |
| Water supply tube (female attachment) | 3/4" |

Available with left hinge (3)

Installation niche features

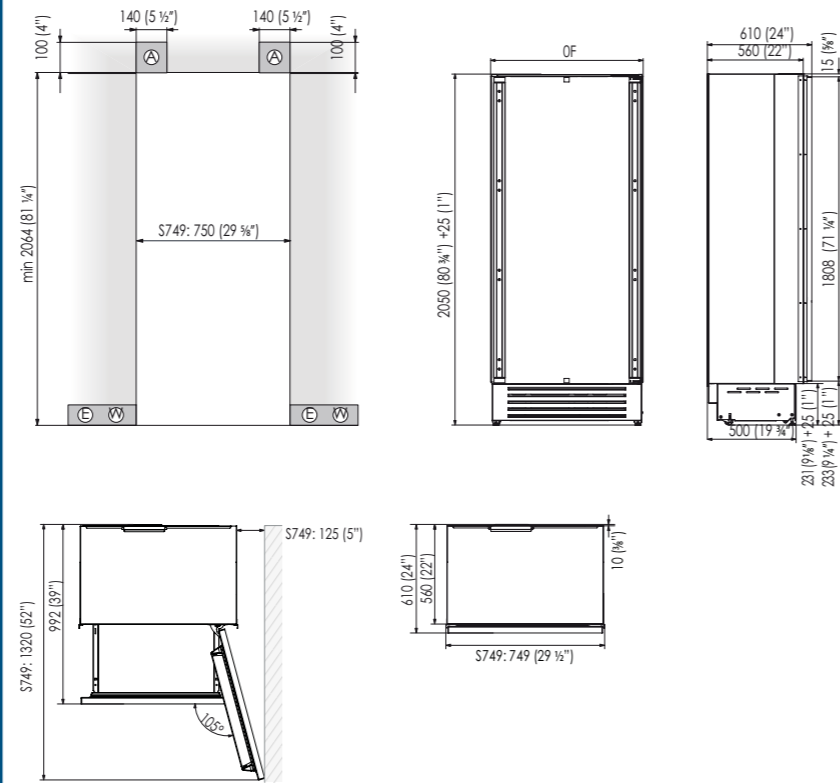

Accessories

| Description | Code |
|--|--------------|
| Stainless steel sides | FKK65F |
| Joining kit - central (Joining brackets, airflow separation included) | KCCIT |
| Joining kit - central (models with stainless steel sides) Joining brackets, airflow separation included+anti-condensation kit) | KCCITX |
| Extra Length Anti-tipping Kit | B04000900 |
| Anticondensation Kit adhesive 1,6 cm thick | KAC16 |
| Cleaning kit microfiber cloth and 1 magic sponges | RP00KP |
| Water filter | RP00FA |
| Transformer for network integration with alternative energy (photovoltaic and geothermal energy, home automation, etc.) | KITNRG899749 |
| Vertical tubular handle | HV |

Flush installation

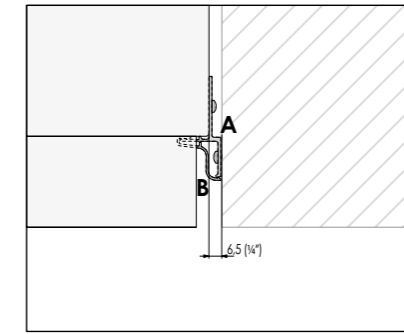

The Lateral Connection Kit (KCLIT/KCLIH/KCLMT/KCLMH) is supplied on all models (except in the unit with stainless steel sides) and consists of a connection element (A) and a aluminium frame (B).

Prominent installation

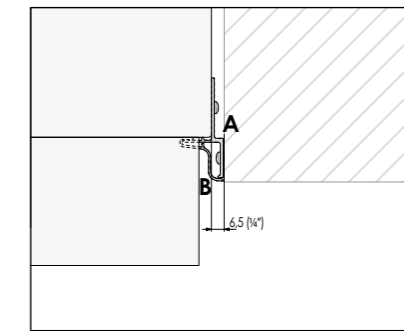

The Lateral Connection Kit (KCLIT/KCLIH/KCLMT/KCLMH) is supplied on all models (except in the unit with stainless steel sides) and consists of a connection element (A) and a aluminium frame (B).

Electrical and Water connection

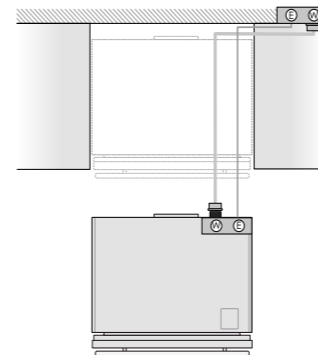

Electrical and Water connection behind the unit

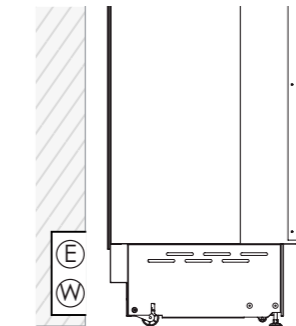

Panel dimensions

Panels with width ranging between 18 mm (3/4 in) and 28 mm (1 1/8 in). Door panels with weight max of 23 kg (51 lb) and drawer panels with weight max of 11kg (25 lb). Provide installation of decorative panels during installation of the unit.

| Series | Door/Drawer Width A | Door Cutout Width B |
|--------|---------------------|---------------------|
| 749 | 747 (29 3/8") | 477 (18 3/4") |

